

# 'CAP ST GEORGES'

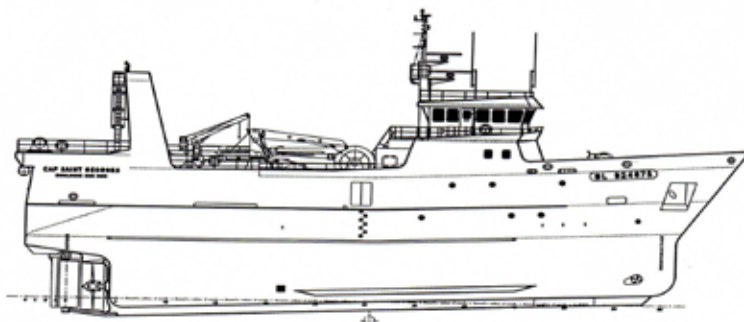

INDUSTRIAL FISHING TRAWLER - 44 m - 430 m<sup>3</sup>



COUPE SUR PONT GALLARD

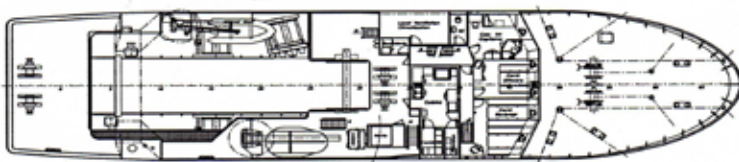

COUPE SUR PONT SUPERIEUR

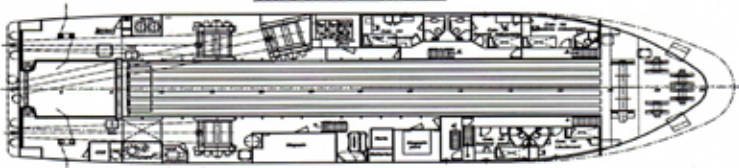

Industrial fishing trawler designed for bottom species fishing and fish conservation at 0°C

- A 430 m<sup>3</sup> hold at 0°C
- A 25 m<sup>3</sup> fish liver oil well
- 2 ice generators
- A 28 m<sup>3</sup> trunk
- 2 garbage collectors
- 13 knots

# 'CAP ST GEORGES'

INDUSTRIAL FISHING TRAWLER - 44 m - 430 m<sup>3</sup>

## MAIN CHARACTERISTICS

Length overall	44.0 m
Breadth	11.0 m
Depth on main deck	4.55 m
Fuel capacity	195 m <sup>3</sup>
Fresh water capacity	30 m <sup>3</sup>
Crew	16
Speed	13 kn
Tonnage	885 UMS
Hull / Superstructure	steel

## SPECIAL EQUIPMENT

### Fishing equipment

Hydraulic winches	3 x 4500 m - Ø 26 mm
Hydraulic arm winches	4 x 270 m - Ø 26 mm
Trawl reel	1 x 16.2 m <sup>3</sup> - 1 x 5.6 m <sup>3</sup>
Gilson/Codend winches	3 x 150 m - Ø 24 mm
Net drum winches	2
Fishing gear automatic control system	

### Fish processing plant

Hold	1 x 0°C / -1°C Total 430 m <sup>3</sup>
Fish liver oil well	25 m <sup>3</sup>
Ice generators	2 - 4 t/d
Trunk	28 m <sup>3</sup>
Regulatory garbage collectors	2

### Crane

Unloading crane

## CLASSIFICATION

Bureau Veritas I ✕ HULL ✕ MACH  
Fishing vessel  
LB 10 years

## MISCELLANEOUS EQUIPMENT

### Fresh water production

Fresh water generators 2 x 3 t/d

### Thruster

Fore thruster 1.8 t - 130 kW

### Anchoring

Anchoring winch  
Switchable reels 2 x 290 m - Ø 30 mm

### Auxiliaries

Garbage incinerator

## PROPULSION / MACHINERY

### Propulsion

Diesel engine 1 x 1850 kW - 750 rpm  
Gearbox Ratio 5.56/1  
Propeller CPP - 4 blades Ø 3400 mm

### Machinery

Genset 1 x 350 kVA  
Driven generator 1 x 1350 kVA