

'AVAL VAD'

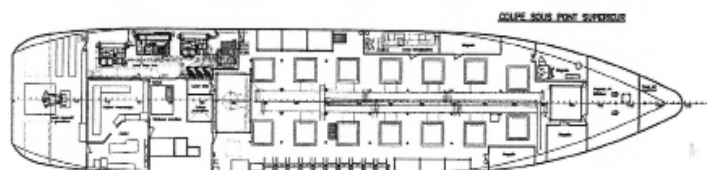

TUNA FREEZER PURSE SEINER - 67 m - 1200 m³

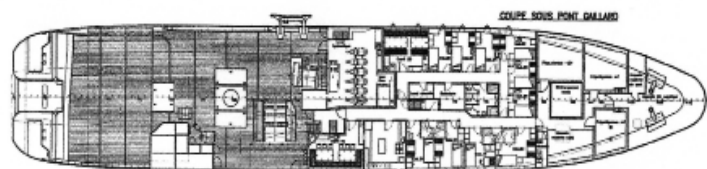
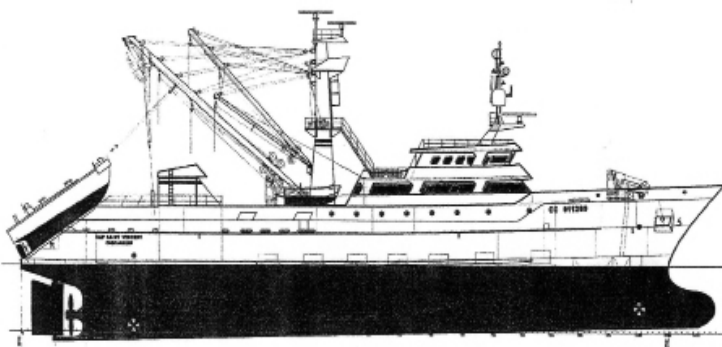

Tuna purse seiner designed for tropical tuna fishing. Dry and brine freezing at -18°C

- 14 holds
- 1200 m³ total storage capacity
- 25 crew on board
- 14 knots

'AVAL VAD'

TUNA FREEZER PURSE SEINER - 67 m - 1200 m³

MAIN CHARACTERISTICS

Length overall	67.30 m
Breadth	12.40 m
Depth on main deck	6.10 m
Fuel oil	350 m ³
Fresh water	30 m ³
Crew	25
Speed	14 kn
Hull / Superstructure	steel / aluminium

SPECIAL EQUIPMENT

Fishing equipment

Seine winches	2 + 1 drums - 35 t 3000 m cable - Ø 24 mm
Power block	1 x Ø 1000 mm - 12 t
Side roller	1 x 9 m - 5 t

Fish processing and storage

Holds	14 - total 1200 m ³
Working area	3 conveyors for unloading

Handling

Fore crane	18 t.m
Aft crane	22 t.m

Work boats

Skiff	steel - 12 m
Speed boat	7 m

CLASSIFICATION

Bureau Veritas

I_{3/3} (E)

Deep sea

Fishing vessel

MISCELLANEOUS EQUIPMENT

Fresh water production

Boilers 2 - 4 t/day

Transversal thrusters

Fore thruster 3.5 t
Aft thruster 3.5 t

Anchoring

Hydraulic windlasses 2

PROPULSION / MACHINERY

Propulsion

Diesel engine 3 000 kW - 750 rpm
Gearbox Ratio 4.16/1
Propeller 5 CPP blades - Ø 3 500 mm

Machinery

Gensets 2 x 800 kVA
Gearbox driven generator 1 x 1500 kVA