

'TELEMAQUE'

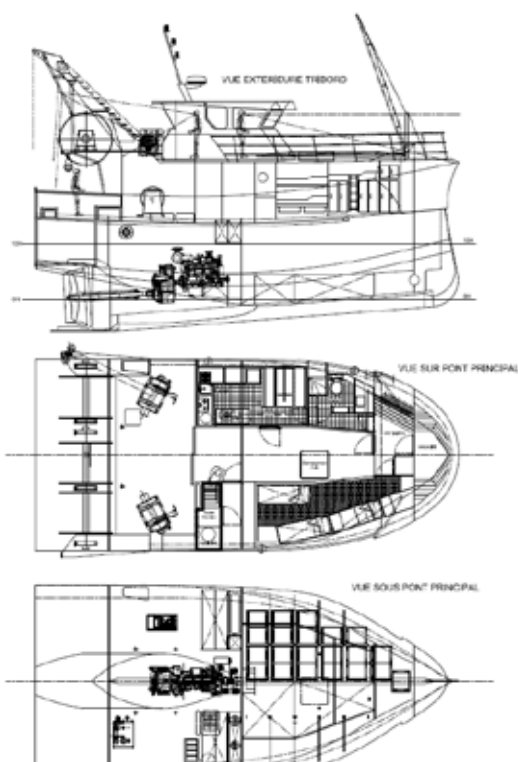

TRAWLER SCALLOPER - 16 m - 42 m³



Artisanal fishing trawler dedicated to scallop fishing and trawling in the Channel. Fish conservation at 0°C

- 42 m³ well
- Propeller tunnel for reduced gasoil consumption
- Three trawl drums with adjustable middle drum
- Aft A-frame structure
- 6 crew members

'TELEMAQUE'

TRAWLER SCALLOPER - 16 m - 42 m³



MAIN CHARACTERISTICS

Length overall	15.95 m
Breadth	7.2 m
Draught	1.9 m
Depth at main deck	3.15 m
Gasoil	12 m ³
Fresh water	2 m ³
Crew	6
Speed	9.5 kn
Gauge	99 UMS
Hull / Superstructure	steel / aluminium

SPECIAL EQUIPMENT

<u>Fishing equipment</u>	
Split winches	2 x 500 m - Ø 20 mm
Trawl drums	3 x 4.6 m ³
Gilson winch	1 x 90 m - Ø 22 mm
Aft A-frame structure	
<u>Fish processing and storage</u>	
Refrigerated well	42 m ³ - 0°C

CLASSIFICATION

Category 2

MISCELLANEOUS EQUIPMENT

Communications

BBFAZR 1513 12 kW radar	1
WASSP system with sensor	1
Wideband hydrophones with Marport M3 receiver	2
NAVTEX FURUNO NX 300 D receiver	1

PROPULSION / MACHINERY

Propulsion

Engine	Cummins KTA 19 - 323 kW
Propeller	fixed pitch Ø 2000 mm

Machinery

Generator	1 x 18 kVA - 1500 rpm
Driven generator	1 x 12 kVA
Driven hydraulic pump	1