

CTV 26m



CREW TRANSFER VESSEL - WINDFARM SUPPORT VESSEL



Developed internally, the 26m PIRIOU CTV benefits from previous Crew Transfer Vessels deliveries to the offshore wind industry and more than 100 crew boats built for the oil and gas sector.

Designed to ensure, in optimal comfort and safety, a fast transfer of personnel and equipment.

This versatile aluminium-built catamaran carries 24 technicians, 4 crew and up to 3x 10 feet ISO containers.

The vessel is 25.8m in overall length and a beam of 9.00m.

With large fuel capacity, high volumes and space for comfortable and functional accommodation, this CTV meets the demanding requirements of wind farms located farther and farther offshore.

The 26m Piriou CTV offers a new modular design and a large range of options.

Powered by two diesel engines driving a controllable pitch propeller (CPP).

To secure zero emission in harbour or during in-field transit or standby, an hybrid propulsion system (with e-motor) is also available.

- Certified Bureau Veritas for windfarm vessels. Compliant with European regulations for the transfer of 24 technicians
- Spacious and comfortable personnel area for 24 persons, mess, galley, changing room, baggage storage facilities
- Modular design
- Spacious decks for cargo capacity, deck crane
- Catamaran hull designed to enhance seakeeping
- Transfer up to 2m significant wave height
- Excellent manoeuvrability provided by a dual CPP propulsion system
- Electrical hybrid propulsion option
- High fuel capacity over 26 m³ to optimize autonomy and wind turbine refuelling

CTV 26m

CREW TRANSFER VESSEL - WINDFARM SUPPORT VESSEL

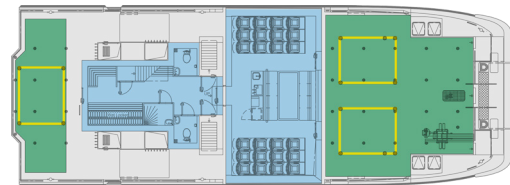

Main deck layout



MAIN CHARACTERISTICS

Length overall	25.80 m
Breadth	9.00 m
Draught (10t deadweight)	1.37 m
Hull / superstructure	aluminium
Crew	up to 4
Industrial personnel	up to 24
Bollard push	18 t
Deck load	10 t
Cargo capacity (foredeck)	1 x 20' or 2 x 10' containers
Cargo capacity (aft deck)	1 x 10' containers
Max. deadweight	25 t
Aft cargo area	18 m ²
Forward cargo area	up to 54.5 m ²
Deck loading capacity	1.5 t/m ²
Fuel	26.4 m ³
Fresh water (domestic)	1 m ³ (3m ³ as option)
Grey/black waters	1 m ³ (3m ³ as option)

OPTIONS

Hybrid or hybrid ready configuration
12 technicians lounge
Wheelhouse extension with survey office arrangement
Crew accommodation in hulls
Compensation bow fender system
Bow thrusters (2 x 30 kW)
Foredeck foldable crane (1.1t @7.60m)
Fuel and fresh water transfer capacity
Pressure washer
Other options upon request

CLASSIFICATION

Bureau Veritas • HULL • MACH
Wind farms service ship - S0, Sea Area 3
Hybrid ZE class notation for hybrid configuration
(Other classification societies upon request)

ACCOMMODATION

Fully air conditioned	20-25°C
With external conditions	-10°C to 35°C
Cabins	2x 2 persons
Resiliently mounted passenger lounge	

PERFORMANCES

Speed @ 85 % MCR (10 t deadweight)	24 kn
Max. speed @ 100 % (10 t deadweight)	26 kn
Range @ 24 kn	1280 NM

PROPULSION / MACHINERY

CPP propulsion system	
Engines	2 x 1066 kW (IMO Tier III)
Generator sets	up to 2 x 40 kW

A hybrid hydrogen-powered version of the Piriou CTV is also under development.